

3-PHASE TRANSFORMER KVA	PAD DIMENSIONS			REINFORCING BARS	
	A	B	C	MK1	MK2
75, 112-1/2, 150, 225, 300, 500	6'-4"	5'-2"	6"	#4 @12"O.C.	#4 @12"O.C.
750, 1000, 1500, 2000	8'-10"	9'-4"	8"	#4 @12"O.C.	#4 @12"O.C.

- GENERAL NOTES:**
- IF THIS SHEET IS NOT 24"x36" USE GRAPHIC SCALE ACCORDINGLY.
  - CONCRETE: 3500 LBS. PER SQ. INCH MIN.; 6% ENTRAINED AIR, 3/4" MAXIMUM SIZE AGGREGATE.
  - REINFORCING STEEL: ASTM-A615 GRADE 60. PLACE AS INDICATED AND SECURELY TIED TOGETHER.
  - MINIMUM CONCRETE COVER OVER REINFORCING STEEL 3" UNLESS OTHERWISE NOTED.
  - WOOD FLOAT FINISH, LEAVING NO DEPRESSIONS.
  - BEFORE POURING SLABS, COORDINATE WITH UTILITIES FOR PLACEMENT OF RACEWAYS.

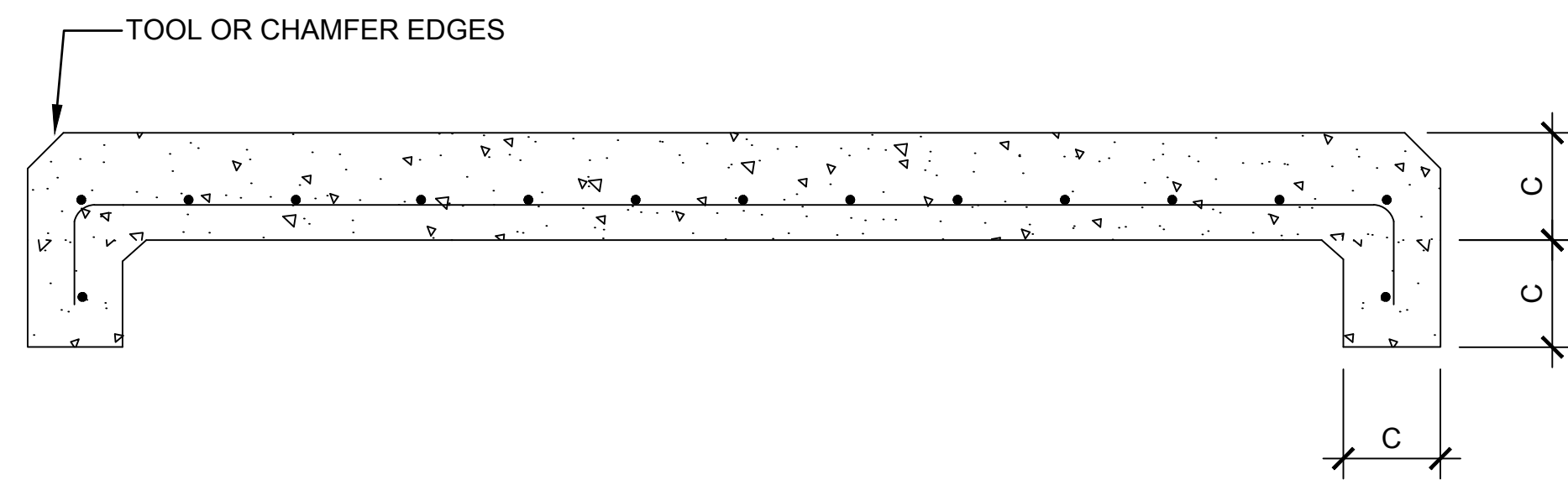

**SECTION A-A**  
SCALE: NONE

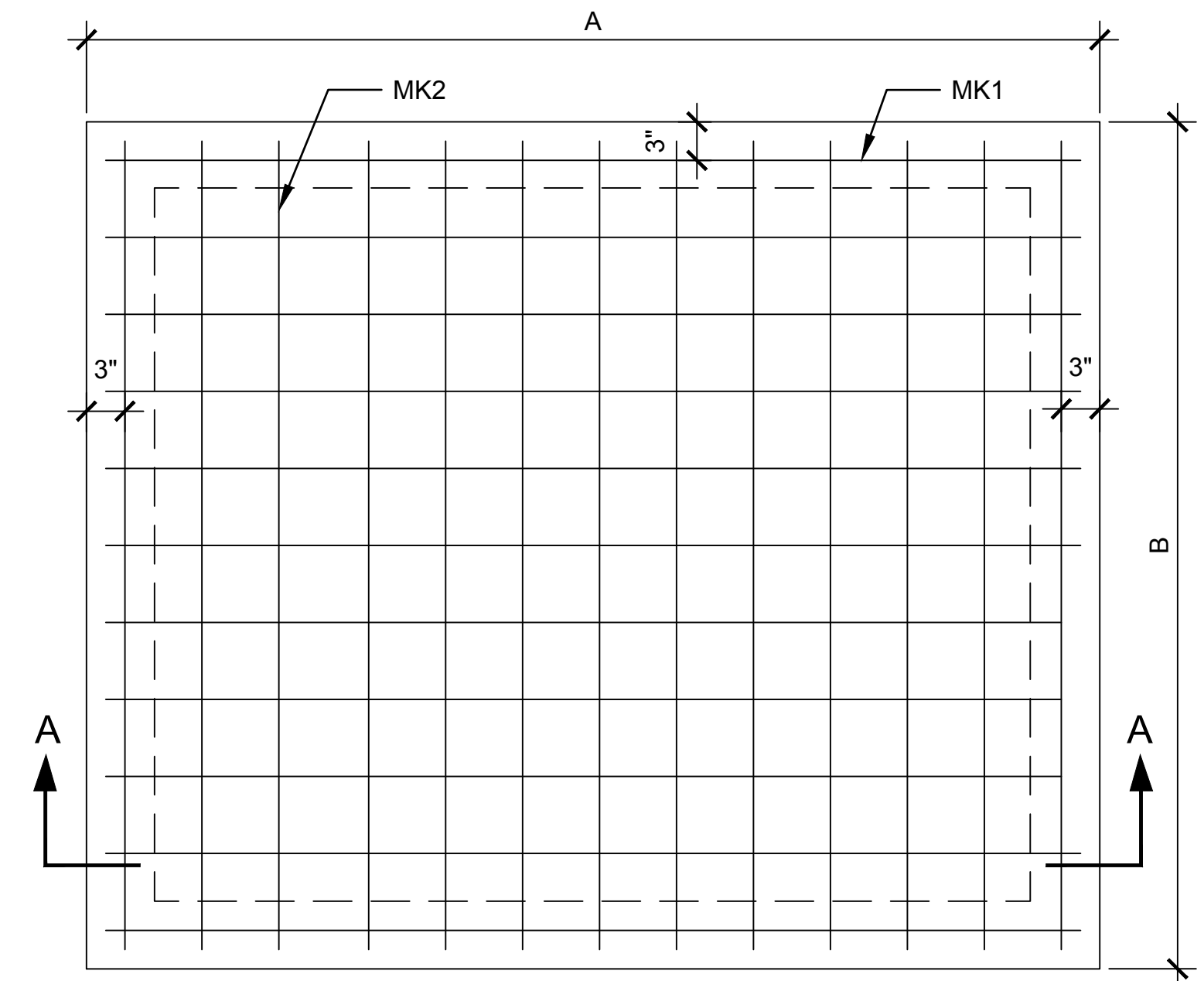

**PLAN**  
SCALE: NONE

NOTES FOR DESIGNER:  
(DO NOT INCLUDE ON CONSTRUCTION DRAWING)

- EDIT TO BE PROJECT SPECIFIC - SHOW DIMENSIONS
- COMPLY WITH CURRENT EDITION OF LANL CAD STANDARDS MANUAL FOR CALL-OUTS PROTOCOL AND LOCATION OF SCHEDULES/MATERIAL.
- ASSIGN AN APPROPRIATE DRAWING NUMBER PER CURRENT EDITION OF LANL CAD STANDARDS MANUAL PROTOCOL FOR DETAILS.

DRAWING DEVELOPED FOR ML-4 PROJECTS. FOR ML-1/ML-2/ML-3, ADDITIONAL REQUIREMENTS AND QA REVIEWS ARE REQUIRED. (REMOVE THIS NOTE WHEN INSERTED INTO A DRAWING PACKAGE).

NO	DATE	CLASS REV	DC	DESCRIPTION	DWN	DSGN	CHKD	SUB	APP
2	5-16-17	UNCLASS	TO	REMOVED BLOCKED OUT AREA FOR CONDUITS & ADDED NOTE FOR CONTRACTOR TO COORDINATE WITH UTILITIES FOR RACEWAY LOCATIONS.	AM	AM	ES	ES	TO
1	9-3-08			ADDED PERIMETER BEAM TO PAD. ADDED NOTE TO SHOW ACTUAL DIMENSIONS	LT	DP	JS	DP	TO

**ENGINEERING STANDARDS**

**ELECTRICAL DISTRIBUTION**

**THREE PHASE TRANSFORMER CONCRETE PADS**

DRAWN	M.DEUTSCH
DESIGN	M.DEUTSCH
CHECKED	J.LANDMAN
DATE	9/30/02

TA-XX BLDG XXXX

APPROVED FOR RELEASE  
STANDARDS MANAGER: TOBIN ORUCH

**E-1**

**1** OF **1**

D.C.: U REVIEWER: MICHAEL LADACH DATE: 9/30/02

PROJECT ID DRAWING NO REV

**CHAPTER 7 ST-G4010-38 2**

00% REVIEW  
NOT FOR CONSTRUCTION